



**MEET.
PARTY.
SPECTATE.**

**SEAT UNIQUE
RIVERSIDE**

“

“I wanted to say a huge thank you, to you and your team for all of your help and support with our surgical conference. It was a huge success and everything ran smoothly. Wendy looked after us so well - she was helpful and even managed to find speakers for us to enhance the experience for colleagues joining the call via Teams. Nothing was too much trouble and I think that she should be nominated for an award! The room, catering, Wi-Fi and parking were excellent - so good that we have rebooked our next event already. Please extend our thanks to all staff.”

South Tees Hospital NHS Foundation Trust, 28th May 2022.

FROM CONCEPT TO COMPLETION



Host your next event at Seat Unique Riverside and enjoy a stunning backdrop to celebrate with. Whether you are looking for private function rooms or a contemporary conference space, there is nothing like hosting your event with a backdrop as timeless as our traditional English cricket ground. No matter what the occasion The Riverside in Durham is the perfect venue.

Our unique venue offers a truly memorable experience for any conference, meeting or private event, away from the distractions of the city. Located in the heart of County Durham our location provides a fresh setting to your conference or event.

We pride ourselves on being able to offer essential amenities including: Free Wi-Fi, Disabled Access and onsite car parking. Our relaxed, charming surroundings, excellent service and top quality food makes us the premier venue in County Durham.

Our meeting packages include on-site room hire, whiteboard and flipcharts, pens and stationery, free parking and mineral water. All of our function rooms are equipped with LCD projectors and screens, with a total capacity of 250 delegates. We also have 15 executive boxes that can be booked separately, suitable for boardroom style smaller meetings.



MEET DAY DELEGATE RATES



£28.50pp

Room Hire
Projector & Screen
Flip Chart
Pad & Pen
Arrival Tea & Coffee
Mid-morning Tea & Coffee
Chefs Artisan S&wich Selection
4 Items from the Finger Buffet Selector
Or choose the Fork Buffet
Mid-afternoon Tea, Coffee & Biscuits

£33.50pp

Room Hire
Projector & Screen
Flip Chart
Pad & Pen
Arrival Tea, Coffee & Danish
Mid-morning Tea, Coffee & Biscuits
Chefs Artisan S&wich Selection
6 Items from the Finger Buffet Selector
Or choose the Fork Buffet
Mid-afternoon Tea, Coffee & Treat

£38.50pp

Room Hire
Projector & Screen
Flip Chart
Pad & Pen
Arrival Tea, Coffee & Bacon Stottie
Mid-morning Tea, Coffee & Biscuits
Hot Fork Lunch
Mineral Water & Juice Served with Lunch
Mid-afternoon Tea, Coffee & Treat

Coordinator Advice:
One size doesn't always fit all, we will happily tailor-make a package to suit your specific event.

NOW PICK YOUR SCRAN >>>

THE BORING (BUT IMPORTANT) STUFF!

All DDR packages include free car parking onsite and free delegate dedicated Wi-Fi.

There is no minimum number required to book Day Delegate Rates.

Please notify your event coordinator of any special or dietary requirements.

Strict hygiene procedures are followed in our kitchen but due to the presence of nuts in some products there is a small possibility that nut traces may be found in any item. Please let your coordinator know of any allergens or dietary requirements prior to arrival.

A WELL FED TEAM IS A HAPPY TEAM



FINGER BUFFETS Includes Chefs Selection of Artisan Sandwiches

THEN PLEASE CHOOSE 4 OF THE FOLLOWING OPTIONS:

Southern Fried Chicken Strips Served with BBQ Sauce

Mini Steak Pies

Cod Goujons Served with Tartare Dip

Panko Butterfly King Prawns with Sweet Chilli Sauce

Sausage Rolls with Apple & Ale Chutney

Vegetable & Feta Cheese Quiche (V)

Italian Vegetable Pizza (V)
Cherry Tomato, Green Pesto & Mozzarella Skewers (V)

Vegetable Samosas & Spring Rolls Served Mint Raita (V, VE)

Sweet Potato Fries (V, VE)

Mozzarella Cheese Sticks with Sriracha Mayo (V, VE)

Vegetable Crudités with Assorted Dips (V, VE)

Sea Salt Roasted Potato Wedges with Assorted Dips (V, VE)

ADD THE FOLLOWING:

Mixed Salad £1.50pp

Seasonal Assorted Desserts £3.95pp
(Served Buffet Style)

V – Vegetarian

VE – Vegan

PP – Per Person

FORK BUFFETS Minimum 10

PLEASE CHOOSE: 2 Main Dishes & 1 Vegetarian Dish (All dishes are presented with the sides below).

Mains

Beef Lasagne Served with Garlic Bread

Strips Of Chicken in a Sweet Pepper Cream Sauce

Chilli Con Carne with Sour Cream & Chives

Chicken In a Katsu Curry Sauce

Fricassee Of Salmon with Cod & Prawns Served in A Cajun Spiced Tomato Salsa

Spicy Tagine of Lamb served with Moroccan Cous Cous

Beef Bourguignon with a Herb Scone

Honey, Ginger & Soy Pork Medallions

Vegetarian Options

Three Bean Chilli Topped with Sour Cream & Chives (VE)

Potato Gnocchi with Cherry Tomatoes, Peas & Parmesan Pesto Cream

Penne Pasta, Courgettes with Sweet Pepper & Tomato Ragout (VE)

Thai Green Vegetable Curry
Spinach & Ricotta Stuffed Cannelloni Bake
Vegetable Lasagne

Sides

Roasted New Potatoes | Vegetable Basmati Rice | Seasonal Vegetables | Mixed Chopped Salad





LOOK, LISTEN AND LEARN!



Screen £25 | Flipchart £25 | Lectern £35 | Projector £85
Laptop £100 | PA System (2 speakers) £120
PA System (4 speakers) £140 | DJ Hire £250 |
Microphone Hire £45 each
(Your choice of lapel, lectern and handheld)
LCD 40" TV Hire £55 per TV | AV Technician (All day) £200

All other equipment can be hired at an additional charge.
We also offer screen splitting for larger conferences at
an additional cost. Please advise your event coordinator
should you wish to order further equipment.

Coordinator Advice:
Our AV suppliers are
experts in their field,
so if you're completely
stuck, they'd be happy
to advise on a possible
solution.

PARCHED?



Individual Prices:

All items priced per person unless otherwise stated
Tea, Coffee and Breakfast Roll £7.50pp
Tea, Coffee and Danish Swirls £6pp
Tea and Coffee £2.20pp
Tea, Coffee and Biscuits £2.95pp
Tea, Coffee and Cake £4.80pp
Soup with a Chefs Artisan Sandwich Selection £9.50pp
Fruit Platter £9.95 (Serves 5 people)
Jug of Orange Juice £9.95 (Serves 5 people)



PARTY



The Riverside is the perfect venue for any occasion with rooms that can hold anything from 20 to 250 people. Our function rooms are ideal for weddings, engagements and anniversaries or for celebrating a special birthday. With great food and drink packages, the County Durham Riverbank is the perfect backdrop, making your event one to remember.

THE PARTY PACKAGE £19.95PP

Suite Hire
Duty Manager to Oversee Event
Dedicated Events Coordinator
Hot Finger Buffet
DJ, Disco and Lighting
White Table Linen
Cake Knife and Stand
Personalised Table Plan
Card Only Bar

THE SCRAN!

CHEFS SELECTION OF ARTISAN SANDWICHES. (4 TYPES)
THEN PLEASE CHOOSE 4 OF THE FOLLOWING OPTIONS:

Southern Fried Chicken Strips with BBQ Sauce
Chicken Tikka Skewers with Mint Raita
Honey Grain Mustard Mini Sausages
Lamb Kofta Kebab with Mint Yoghurt
Mini Cheeseburger Sliders
Pepperoni Pizza
Spiced Cod & Crab Bites Served with Sweet Chilli Sauce
Mini Mince Beef Pies
Corned Beef Roll Bites
Cheese Roll Bites (V)
Halloumi Fries (V)
Cheesy Garlic Bread (V)

Bhaji, Samosa & Pakora's Served with Mango Mayo (V, VE)
Sea Salt Roasted Potato Wedges with Assorted Dips (V, VE)

ADD THE FOLLOWING:
Seasonal Gateaux or Cheesecake £3.95pp
(Served Buffet Style)

V – Vegetarian
VE – Vegan
PP – Per Person

Coordinator Advice:
Don't know where to start? Do you have a dream event in mind? Tell us about it! There's no such thing as too much detail, we need to know as much as possible to make your ideas come to life.

MAKE IT ONE TO REMEMBER

Arrival drink starting from
£3.95 per person
Chair Covers & Organza Sash
£2.95 per chair
Photobooth with Props £400
Table Centerpieces
Starting from £25 per table
Balloons starting from
£8 per table



DANCING THE NIGHT AWAY?

RESIDENT DJ & DISCO - INCLUDES PA & DISCO LIGHTS - £250
ROOM UPLIGHTER'S (X10)- £150
LED DANCEFLOOR (10FTX10FT) -£275
LED DANCEFLOOR (12FTX12FT) - £325
LED DANCEFLOOR (14FT X 14FT) -£375
ADDITIONAL DISCO LIGHTING - £100

THE BORING (BUT IMPORTANT) STUFF!

Strict hygiene procedures are followed in our kitchen but due to the presence of nuts in some products there is a small possibility that nut traces may be found in any item. Please let your coordinator know of any allergens or dietary requirements prior to arrival.

Coordinator Advice:
We're a cashless venue, we only accept debit and credit cards on our bars. Don't forget to remind your guests!







Coordinator Advice:
Book an unforgettable matchday experience with friends, family or colleagues! Don't wait too long if you want to be part of the most popular matches! Hospitality tickets for these special events can sell out months in advance.

SPECTATE HOSPITALITY & MATCHDAYS



Join us for a full days hospitality and enjoy some of sports best networking opportunities. Whether entertaining all day at our International fixtures, or taking in the shorter fast paced action at a T20, there is nothing more quintessentially English that a day at the cricket. No other sporting hospitality provides a full days entertainment for your clients and colleagues in a friendly and relaxed atmosphere.

“Durham Cricket’s hospitality offered us fantastic opportunities to meet and host guests throughout the season. The service, food and atmosphere were exceptional. We look forward to another great season in 2023.”

BPP Visual, 2022

T20

Ground admission
Private box or lounge places
Food & drink included
Waitress service
Complimentary car parking 1:4
Complimentary matchday programmes and scorecards

**Lounge package
£155 + VAT PP**

**Hospitality Box
£2,500 + VAT**

50L CHAMPIONSHIP

Ground admission
Private box or lounge places
Freshly brewed tea, coffee and breakfast refreshments on arrival
Lunch
Traditional afternoon cricket tea
Inclusive drinks package
Match day scorecard
Complimentary car parking 1:4

**Lounge package
£125 + VAT PP**

**Hospitality Box
£995 + VAT**

COUNTY CHAMPIONSHIP

Ground admission
Private box or lounge places
Freshly brewed tea, coffee and breakfast refreshments on arrival
Lunch
Traditional afternoon cricket tea
Inclusive drinks package
Match day scorecard
Complimentary car parking 1:4

**Lounge package
£90 + VAT PP**

**Hospitality Box
£995 + VAT**

MATCHDAY EXPERIENCE (SEASON TICKETS AND GENERAL ADMISSION)

For the perfect matchday experience at Durham Cricket, nothing beats a season ticket. That way, you can enjoy all of our domestic fixtures and get to know some of our most devoted supporters. But if that isn't for you, don't worry – there are still plenty of ways to get involved with Durham Cricket! General admission tickets give you access to our biggest games and matches, meaning everyone is welcome regardless of their budget. So no matter what kind of experience you're after, you're sure to find something to suit you.

DURHAM CRICKET MEMBERSHIP

Includes all T20, 50L and County Championship games at Seat Unique Riverside. **Start from £180.**

For all fixtures please go to: www.durhamcricket.co.uk

GENERAL ADMISSION

Come just for one match this season.
Starting from £12

THE GEOFF COOK SUITE



The Geoff Cook Suite is our largest and most impressive event space within the stadium.

This floor-to-ceiling glass fronted space overlooks one of the most picturesque settings in English sport providing the backdrop to an unrivalled event space. Seating a maximum of 220 people for a dinner, it's the perfect setting for the grandest of events. Whether you're looking for a conference, private dinner or school prom we've got it all covered.

| Dimensions | | Layout / Capacities | |
|------------|-----------|---------------------|-----|
| Length | 51 Metres | Theatre | 300 |
| Width | 8 Metres | Cabaret | 200 |
| Height | 8 Feet | Open Square | 50 |
| | | Banquet | 22 |
| | | Dinner Dance | 200 |
| | | Exhibition Stands | 50 |

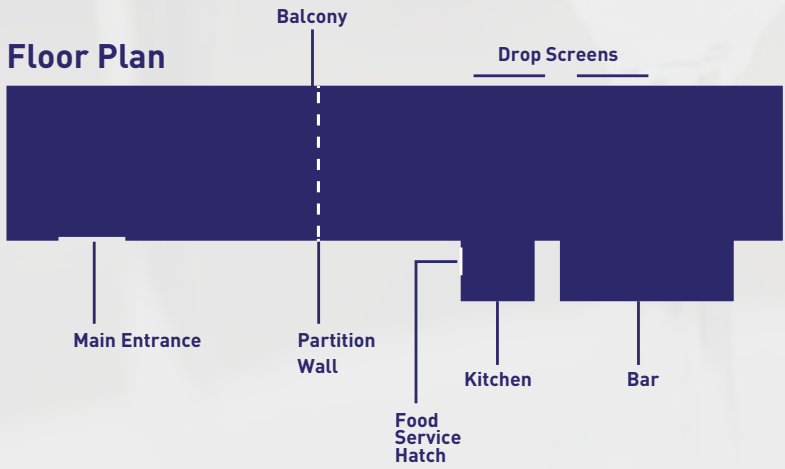

WHY CHOOSE THIS ROOM?

The large balcony attached to the room is the perfect champagne moment. Sneak out or organise a photo moment that packs a punch. There is no comparison to our breath-taking views.





THE CASTLE VIEW SUITE



As the name of this suite suggests, it focusses on the fantastic 18th Century castle positioned directly in front of the room. Overlooking the riverbanks of Chester-le-Street Riverside park, the Castle View is the perfect pitch-facing solution for either small intimate gatherings or larger events.

The contemporary design of the room lends itself to anything from corporate meetings to the most glamorous of events. With the Castle View, you can create the perfect atmosphere for any occasion.

| Dimensions | | Layout / Capacities | |
|--------------|------------|-----------------------|-----|
| Length | 205 Metres | Theatre | 100 |
| Width | 11 Metres | Cabaret | 80 |
| Height (Max) | 8 Feet | Boardroom | 40 |
| | | U shape / Open Square | 40 |
| | | Banquet | 120 |
| | | Dinner Dance | 100 |
| | | Exhibition Stands | 14 |

Floor Plan

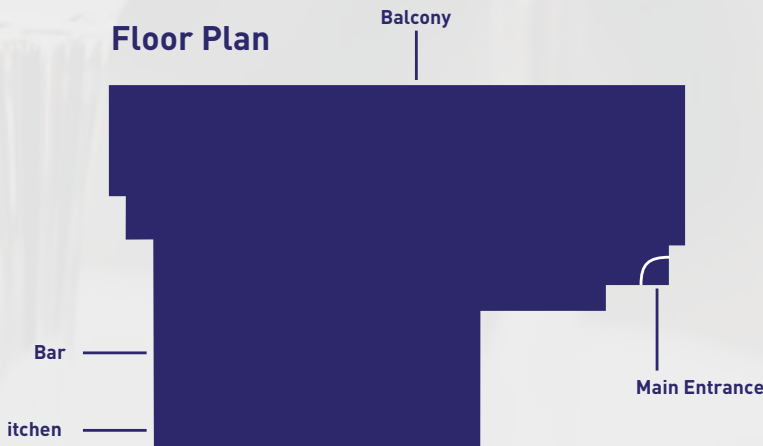

WHY CHOOSE THIS ROOM?

This is our signature function space for private parties. With a neutral pallette the room lends itself to conferencing, but is perfect for weddings, christenings or a special birthday. The dynamic L-shape of the room breaks the area up nicely to hold your dancefloor, private bar and buffet area making sure there are no crowded areas.





The Cathedral Suite features a large open space with high ceilings creating a unique atmosphere that can be used for anything from conference to wedding ceremonies.

The floor to ceiling windows in the room make use of natural daylight to highlight the contemporary design. Having a large car park opposite means that you can create an event on the ground floor with indoor or outdoor exhibition space for vehicles, shell schemes or play equipment!

| Dimensions | | Layout / Capacities | |
|--------------|------------|-----------------------|-----|
| Length | 137 Metres | Theatre | 150 |
| Width | 14 Metres | Cabaret | 120 |
| Height (Max) | 9 Feet | Boardroom | 40 |
| | | U shape / Open Square | 50 |
| | | Banquet | 120 |
| | | Dinner Dance | 100 |
| | | Exhibition Stands | 20 |

Our meeting lounges feature a pitch-facing view of the stadium, providing a perspective that can only come from sitting in the middle of the action.

The four signature meeting lounges are perfect for breakout spaces, intimate dinners or parties. Each lounge has their own private bar within the room and is separate from any other room, offering an exclusive space away from disruption.

| Dimensions | | Layout / Capacities | |
|--------------|------------|-----------------------|----|
| Length | 145 Metres | Theatre | 60 |
| Width | 6 Metres | Cabaret | 40 |
| Height (Max) | 7.6 Feet | Boardroom | 24 |
| | | U shape / Open Square | 15 |
| | | Banquet | 50 |
| | | Dinner Dance | 40 |
| | | Exhibition Stands | 6 |

WHY CHOOSE THIS ROOM?

Our most versatile space! The shape of the room particularly lends itself to conferencing, workshops and team building exercises. If the subject matter is important the room is great for focus as it isn't pitch facing.

Floor Plan

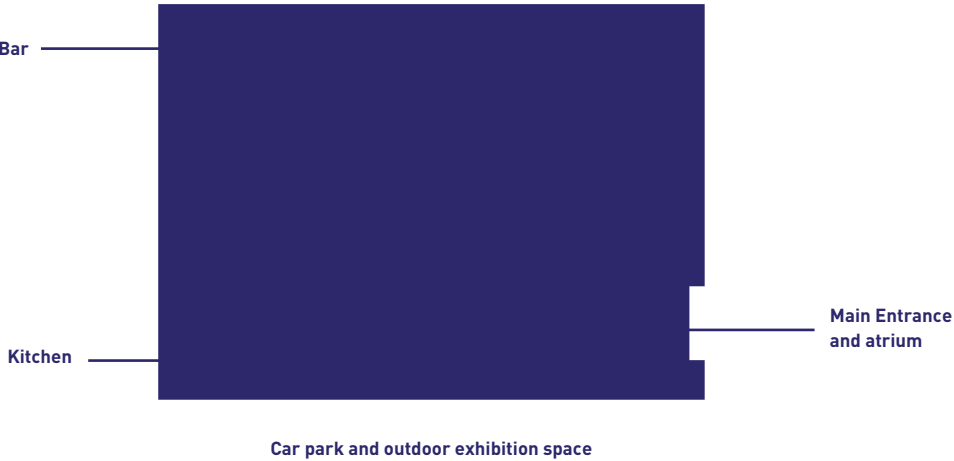

WHY CHOOSE THIS ROOM?

Meeting Lounges are perfectly suited for any small to medium sized conferences or intimate gatherings. Top Tip: Adjacent to these rooms are our executive boxes which are perfect breakout spaces for interviews, collaborative working or training.

Floor Plan

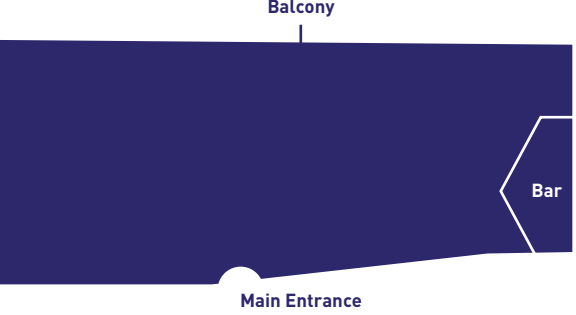



DURHAM CRICKET



Ythan Sale
Events Manager

0191 387 2815

ythan.sale@durhamcricket.co.uk



Jo Morris
Events Coordinator

0191 387 2876

jo.morris@durhamcricket.co.uk

WWW.DURHAMCRICKET.CO.UK/EVENTS